



3560 Nevada St. Pleasanton, CA 94566

925-454-2361 (office) 925-454-2367 (fax)

## Fire Truck Specifications for Fire Apparatus Access

The Fire Department has adopted California Fire Code Appendix D – Fire Apparatus Access Roads.

Fire Department access design is based upon the fire truck. The required turning radii for the truck are:

- Inside: 45 feet
- Outside: 55 feet

Truck specifications are:

Category	Specification
Length	41'-6"
Width	9'-6"
Lock to Lock time	6.0 seconds
Steering Angle	38 degrees
Wheel base	248" from front axle to centerline of rear axles
Bucket overhang	6'-6" from front bumper
Centerline of rear axles to back bumper	13'-4"
Weight	69,000 lbs.

Buildings over 30 feet tall require truck aerial ladder access locations. These locations must be a minimum of 26 feet wide. Their locations will be determined on a case-by-case basis during the planning process.

Diagrams of acceptable turnarounds are on the next page. Other designs will be considered on a case-by-case basis.

### Annual Fire Inspection Program Standard #9 Fire Lanes

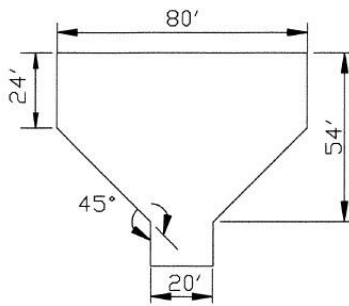

"T" HAMMERHEAD  
(CHAMFER ALTERNATIVE)

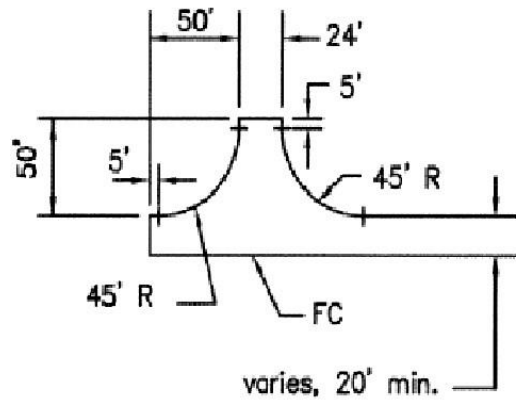

DOG LEG HAMMERHEAD

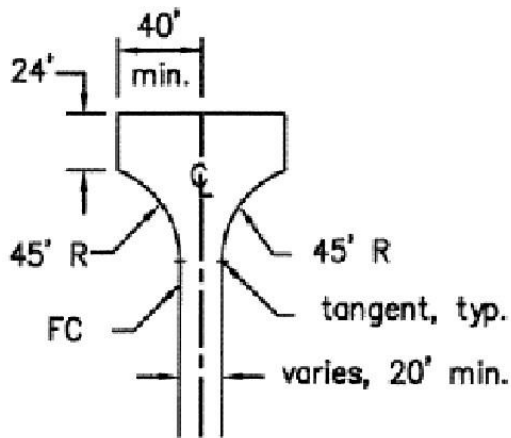

"T" HAMMERHEAD

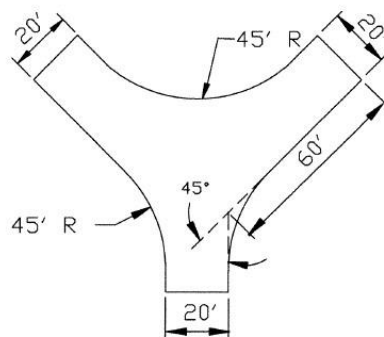

60' "Y"

